

Suggested PCB Layout  
Tolerance: ±0.05

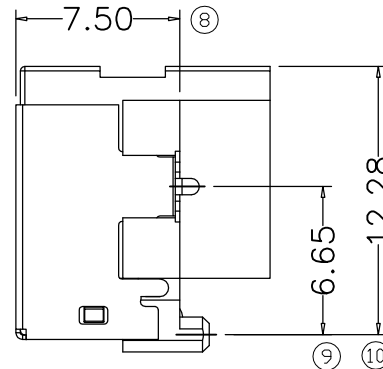
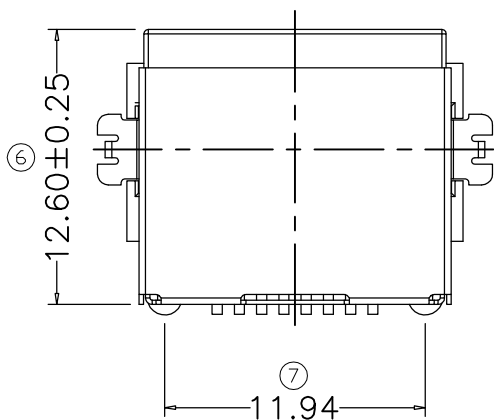

**ELECTRICAL:**

- VOLTAGE RATING: 125 VAC RMS
- CURRENT RATING: 1.5 AMP
- CONTACT RESISTANCE: 20MΩ MAX.
- INSULATION RESISTANCE: 500MΩMIN. AT 500V DC.
- DIELECTRIC STRENGTH: 1000 VAC 50HZ 1MINUTE.

**MECHANICAL:**

- HOUSING MATERIAL: LCP UL94V-0 RATED, COLOR BLACK.
- CONTACT MATERIAL: PHOSPHOR BRONZE.
- CONTACT PLATING: PLATED NICKEL 50U"MIN. UNDER PLATING ALL, PLATED TIN ON SOLDER TAILS 100U" MIN. GOLD PLATED ON CONTACT AREA FU".
- SHIELD: COPPER ALLOY PLATED WITH NICKEL 30U"MIN.
- OPERATING LIFE: 750 CYCLES MIN.
- MATING FORCE: 22.24N MAX. UNMATING FORCE: 44.48N MAX.
- REFLOW SOLDERING TEMP.: 260°±5° 5-10 SECONDS.
- JACK CAVITY CONFORMS TO FCC RULES AND REGULATIONS PART 68, SUBPART F.

**ENVIRONMENTAL:**

- STORAGE: -40°C TO +85°C
- OPERATION: -40°C TO +85°C

**SCHEMATIC**

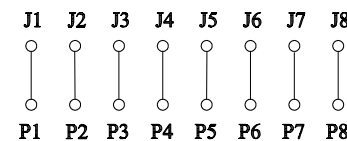

DETACHED LISTS			绘图: (Designed)		<h1 style="text-align: center;">Coorle Technology</h1>	
	公差: TOLERANCES		审核: (Checked)			
	MM	MM	批准: (Approved)		系列 (SERIES)	名称 (NAME)
	.0 ± 0.38	±	日期: (Date)		RJ	RJ45 8P8C 全包沉板SMT式H7.5
	.00 ± 0.25	±	比例: (SCALE)		类别CATEGORY:	成品图
.000 ± 0.15	±	角度 (ANGLES) ± 1.5°		2024.03.12	料号 PART NO: 1060-208021	版本 REV. A.0
 第三角视图				1:1	单位 (UNIT): MM	共 (SHEET) 1 页 第 (OF) 1 页